



Rendering subject to change



OceansforAll

IMPROVING ACCESS TO MARINE
SCIENCE AND TECHNOLOGY

Learn more about Mote's
Oceans for All campaign online at:

MOTEOCEANSFORALL.ORG

MOTE SCIENCE EDUCATION AQUARIUM

Our vision: Improving communities' access to marine science and technology while enabling Mote's scientific progress on City Island, Sarasota

A young child's eyes light up as she catches her first glimpse of Mote Science Education Aquarium: Its three stories seem to ripple and swirl like rising ocean currents—it's like no place she's seen before, and it's hers to explore. Once inside, she discovers more than 1 million gallons of living ocean exhibits with corals, sharks and manatees, hands-on teaching labs that offer no-cost opportunities, and much more. Her school can't afford many field trips to the coast, but this eager student can explore the ocean and participate in citizen science at Mote Science Education Aquarium (Mote SEA), the new public outreach facility being planned in mainland Sarasota County by the world-class Mote Marine Laboratory.

This is our vision.

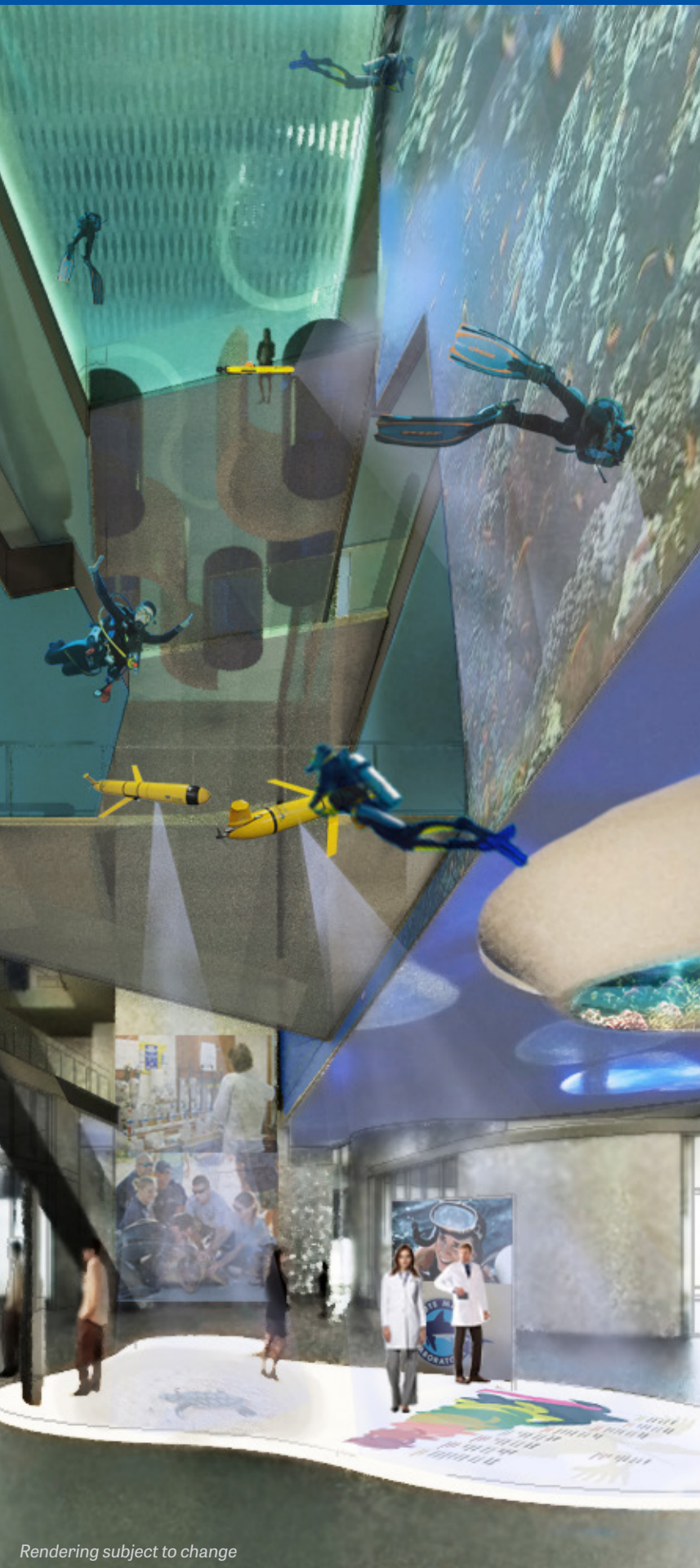

Mote Marine Laboratory has led ocean research for more than 67 years in southwest Florida, with its current research campus on City Island, Sarasota, powering most of Mote's annual economic impact: nearly \$80-million. Today, Mote research is advancing so rapidly that it must occupy more of the existing City Island campus space, currently housing Mote Aquarium. Mote sought the best place for its Aquarium to be reborn, through years of careful exploration. In early 2018 Mote announced its goal to build the Aquarium where its 350,000 annual visitors are projected to grow to nearly 700,000: Nathan Benderson Park in Sarasota County.

SERVING A HOTSPOT OF COMMUNITY GROWTH

Near Nathan Benderson Park, the I-75 intersection with University Parkway hosts an average 60,000 drivers on both sides daily, which will allow an expected average of 43 million drivers to view Mote SEA each year. Drivers will easily spot the iconic building, whose diaphanous skin will form smooth ellipses rising into the sky like ripples on a calm sea.

Mote SEA is being planned for 12 acres in the Sarasota County-owned Nathan Benderson Park, through a Mote-county land agreement.

This highly accessible site will double the number of residents and visitors within an hour's drive of Mote's outreach facility.



Rendering subject to change

SCIENCE IS THE ATTRACTION

At Mote SEA, science will be a part of each moment of the visitors' experience, with augmented reality technology creating an immersive ocean biome to explore. Inside the 110,000-square-foot facility, visitors' horizons will expand with glimpses of the deep sea or other remote habitats, including Mote research sites from around the world. Guests will encounter a stunning array of sharks, coral reef species, manatees, sea turtles, otters, seahorses, jellyfish and myriad other wildlife.

Interactive teaching labs will be accessible to all schools in the region, including no-cost opportunities, so that each child has the chance to discover marine science and technology, first-hand. Strategically collaborating with schools and community groups where needs are greatest, Mote will continue to educate children who might not otherwise have access to aquariums and marine science education.



Rendering subject to change

ECONOMIC BOOST

Construction of Mote SEA is projected to benefit Florida's economy by producing \$280 million in direct and indirect expenditures and 3,123 total person-years' employment. Beyond the one-time benefits of new construction, Mote SEA by itself — not including Mote's research enterprise — will support a total of over 260 direct and indirect jobs and provide approximately \$28 million annually in economic benefits for the State of Florida.

CITY ISLAND RESEARCH CAMPUS WILL ADVANCE SCIENCE, BLUE ECONOMY

The rebirth of Mote Aquarium on mainland Sarasota County will lead to the next step in the evolution of Mote's City Island research campus into an enhanced **International Marine Science, Technology & Innovation Park**. This will provide Mote researchers, science and technology entrepreneurs and their international partners much-needed facilities for expanded intensive research and allow Mote's best and brightest to excel in addressing the significant threats facing Earth's oceans. In the coming years, we expect that Mote Marine Laboratory will become the catalyst for a new "Silicon Valley" of marine science and technology in Southwest Florida. The innovations and intellectual property generated by Mote and a growing marine science

and technology sector will fuel an expansion of Florida's blue economy, with impacts felt well beyond our state.

BUILDING MOTE SCIENCE EDUCATION AQUARIUM: OCEANS FOR ALL

Mote has completed extensive site work at the future home of Mote SEA. Vertical construction will begin by the end of 2022, enabling Mote SEA to open in 2024.

To realize our vision for the new Mote SEA — sharing ocean literacy with more people from all walks of life — we are proud to present our capital construction fundraising effort *Oceans for All: Improving Access to Marine Science & Technology*, which aims to secure \$130 million for the new Mote SEA through a combination of philanthropy, corporate and organizational partnership, and public support at local to state levels.

As of March 2022, more than \$95 million has been raised toward our goal.

Learn more online at:
MOTEOCEANSFORALL.ORG